

Facilitations

News & features for facility professionals

Published periodically by



November 2013

PRESIDENT'S MESSAGE

In taking care of the wayward possum issue that I touched on last month, I realized how truly diverse our lives are in the world of facility management. There are few jobs that can be so diverse on a daily basis and how flexible we need to be conquer the large and small obstacles that block our way to success from day to day. Still, every day, we move forward, because, in most cases, that is what we do...overcome obstacles and achieve success.

For the FMs it is about gaining knowledge whenever possible and relying on the advice from our peers. For our partners in the support world, it is about providing products and services that best represent our companies in order to provide that best possible workplace for our common customer, the occupants and visitors to our buildings. Together, that is what makes our bond strong and that is what IFMA is based upon.

At World Workplace each year, we get together as Professional and Associates, Chapters and Councils and States and Countries and learn what it takes to make our businesses strong, our facilities strong, ourselves strong! This year's annual IFMA World Workplace in Philadelphia was no different. We had an opportunity to tour some of the great landmarks and business areas of the Philadelphia, listen to industry leaders discuss major trends and challenges in our work arena and sample some of the finer hospitality the City of Brotherly Love had to offer.

Consistent was the top-notch educational training with topics such as leadership, sustainability, business trends and emergency management we have always known at WWP. Consistent was the incredible Expo and Solution Arena on the floor of the Pennsylvania Convention Center. Finally, consistent were the large and small social events throughout the week that brought old and new friends together from around the world and from just down the road.

This year, our poor cow was abducted and yet abducted again! For a while, it looked as if she would holding over in Boston, but after some trickery and hijinks, Bessie will be spending the winter with our

neighbors in Minnesota. We look forward to seeing pictures of her travels!

Next year's IFMA World Workplace is in the Big Easy and proves to be one of the best yet! I encourage you to mark your calendars for next year's event and take note that it will be even earlier than this year. Let's plan on bringing a large group from IFMA Madison to New Orleans! I think we could just possibly have some fun!

Below and on page 3 of this newsletter are some pix from the Philly event.

Kyle Roux
President



2013-2014 OFFICERS & TEAM DIRECTORS

President

Kyle Roux
University of Wisconsin
262-0381
kroux@chem.wisc.edu

Vice President & President-Elect

Nathan Hanson
CDP, Inc.
608-831-6969
Nathan@cdpcorp.com

Secretary

Patty Sweitzer
TDS Telecom
664-8915
patricia.sweitzer@teldta.com

Treasurer Task Force

Brett Wedekind
Wedekind Enterprises
608-628-2215
brettwedekind@gmail.com

Immediate Past

Mike Schwartz
C. Coakley Relocation
256-6683
mschwartz@ccoakley.com

Show 'n Go



Jon Schneider, Co-Director
577-2407
jonmschneider@tds.net

Ron Rowe, Co-Director
Alliant Energy
458-3493
ronrowe@alliantenergy.com

Member Squad



Roberta Montague, Co-Director
Schroeder Solutions
262-207-6363
rmontague@schroedersolutions.com rmontague@schroedersolutions.com

Lunch Bunch



Robbie Kritz, Co-Director
A&J Specialty Services
576-6323
rkritz@charter.net

J.R. Roethke, Co-Director
UGL Services – Unicco Operations
232-6178
jroethke@yahoo.com

Birdie Brigade



Karyn Biller, Director
Lerdahl Business Interiors
535-2232
KBiller@lerdahl.com

Sponsorship Task Force



Barb Millan, Co-Director
Emmons Business Interiors
441-8900 X21
barbm@ebiweb.com

Lorelle Micklitz, Co-Director
Shred-it
222-6510 or 772-9123
lorelle.micklitz@shredit.com

Team PR



John Desens, Co-Director
Westphal & Co. Inc.
216-9554
jdesens@westphalec.com

Brian Hoffman, Co-Director
Harker Heating & Cooling, Inc.
2255-6902
BrianH@HarkerHeating.com

News Crew



Jennifer Hardebeck, Co-Director
Esurance
608-234-9050
jhardebeck@central.esurance.com

Margaret S. Fisher, Co-Director
Lange Bros. Woodwork Co. Inc.
414-466-2226 ext 121
Margaret@langebros.com

IFMA 2.0



Mary Ann Jargo, Co-Director
PPD, Inc.
608-203-4270
maryann.jargo@ppdi.com

J.R. Roethke, Co-Director
UGL Services – Unicco Operations
232-6178
jroethke@yahoo.com

Community Crew



Doug Sutter, Co-Director
Keller, Inc.
920-766-5795
dsutter@kellerbuilds.com

Gene Post, Co-Director
Potter Lawson
608-274-2741
genep@potterlawson.com

Professional Development Task Force



Erica Marty, Co-Director
Espstein Uhen Architects I
608-442-6696
ericam@eua.com

Leah Samson-Samuel, Co-Director
Madison Environmental Group, LLC
608-280-0800
leah.samson-samuel@madisonenvironmental.com

Madison IFMA Administration

Le and Bob Jordan, Communicators of Wisconsin (COW)
848-1960, fax 848-9266;
ifma@mailbag.com

IFMA International

Tawa Busari, Member Services Manager
IFMA International (Houston)
(713) 623-4362
tawa.busari@ifma.org

Chapter Monthly Luncheon November 19, 2013 12 Noon -CUNA Mutual

The Nov 19 luncheon meeting will be by Scott Olsen of Madison Gas and Electric on BIM and digital facility management practices.

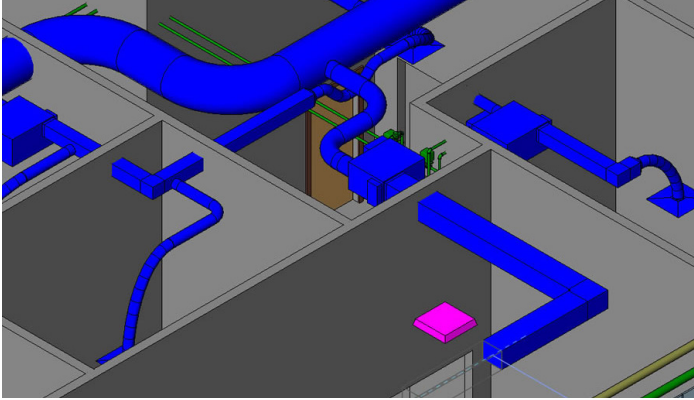

Building Information Modeling (BIM) is a digital representation of physical and functional characteristics of a facility. A BIM is a shared knowledge resource for information about a facility forming a reliable basis for decisions during its life-cycle; defined as existing from earliest conception to demolition. Use of BIM goes beyond the planning and design phase of the project, extending throughout the building life cycle, supporting processes including cost management, construction management, project management and facility operation. Click [HERE](#) to register.

November Tour Could be EPIC!!

Tentative tour information: we are currently working on a tour of Epic during the week of November 18th. More info to come!

More Photos from IFMAison's Excellent Adventure at World WorkPlace in the The City of Brotherly Love

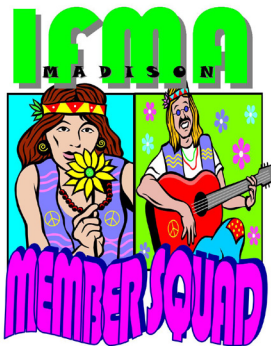

Member Squad welcomes New Member Carrie Mayer from Brothers Business Interiors, who has also joined our team! Further, welcome back Richard Pierce, retired former National IFMA president. Member Squad is growing, currently with 5 members on board. Wanna be part of the grooviest team in IFMA-Madison? Contact Roberta Montague (206-4614) or Jim Zirbel (235-5885) to join us!

Member Squad exists to make your IFMA member experience a great one, getting something good from IFMA right away. If you are a new member or want to understand the chapter better, you're invited to our next New Member Breakfast on Thursday January 9th, at the Egg & I in Arbogate on Todd Dr. & the Beltline Hwy.

Member Squad New Member events always have

- Great Food
- Great People
- A great way to get started with IFMA

Professional Development Task Force

Invites you to our:

Think and Drink Planning Session

Bring your brilliance and humor, we will provide the beer.

The Brass Ring
701 E Washington Ave
6:00-7:00
Tuesday November 12th

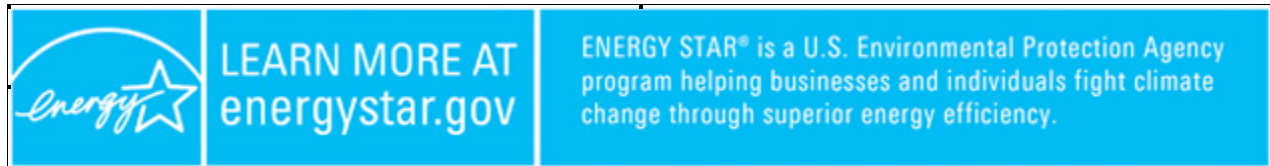

Two-week extension to apply for 2013 ENERGY STAR certification

Because we had to take Portfolio Manager offline for two weeks, many of you may be challenged to meet the November 15 deadline to apply for 2013 ENERGY STAR certification. To that end, we have decided to extend this deadline until Wednesday, December 4 for commercial buildings.* You now have until Wednesday, December 4 to apply for 2013 ENERGY STAR certification for your buildings.

Learn more about applying for EPA's ENERGY STAR, or start filling out your application in Portfolio Manager today (Don't worry: You can save an unfinished application in your Portfolio Manager account and finish it later.)!

Thank you again for your patience during the recent government shutdown. We are all thrilled to be back at work and look forward to working with you, our partners, to continue reducing greenhouse gas emissions from our nation's buildings and plants.

Courses of Interest for IFMA, UW–Madison Engineering Professional Development

The Department of Engineering Professional Development (EPD) at the University of Wisconsin-Madison offers courses of interest to International Facility Management Association (IFMA) members, including courses focusing on building systems, commissioning, green and high performing buildings, and management.

Taught by expert instructors at a top-rated engineering university, EPD's continuing education opportunities are designed to help you advance your technical skills and career.

EPD offerings include:

- Courses
- Certificates
- Masters Degrees

[For questions and registration information](#)



IFMA Edison Green Corner

IFMA Hosts a Variety of Resources to Better Yourself & Your Organization

IFMA hosts a variety of resources to better yourself and your organization. The Sustainability Facility Professional assessment-based certification program is one way to impact the economic, environmental and social aspects of your facility by providing practical and immediate solutions. There is a missing link in leading, managing and operating a sustainable site, and that is how to maintain your facility after certification. The SFP prepares you and your facility for recertification by educating employees and providing new sustainability ideas in a challenging, yet constructive manner. This competitive advantage will give you recognition and credibility as someone who can effectively improve building efficiency, promote internal training, and strengthen your organization's image.

The focus areas are as follows: Strategy and Alignment for Sustainable Facility Management, Managing Sustainable Facilities, and Operating Sustainable Facilities. As stated by IFMA, these focus areas will provide you with the tools and knowledge to:

- Integrate sustainable efforts with the organizations values and strategies

- Present a business case for a sustainable initiative

- Evaluate initiatives from a financial point of view, and track and report accomplishments

If you wish to see how SFP can be utilized in real-world scenarios, take a look at the Success Stories here:

<http://www.ifmacredentials.org/sfp/earn-your-sfp-credential/success-stories>

The SFP is intended for those with a foundational knowledge of facility management and interest in sustainable practices. Visit this link to find out more about your compatibility with the program:

<http://www.ifmacredentials.org/sfp/earn-your-sfp-credential/who-should-become-an-sfp>

If you wish to pursue this valuable opportunity, IFMA Headquarters, IFMA chapter, training affiliates, and local colleges and universities offer the SFP Credential Program course. Visit this link to find participating locations near you:

<http://www.ifmacredentials.org/sfp/classes-offered>

Additional resources:

How Does the SFP Compliment LEED

<http://www.youtube.com/watch?v=keAoDGOsYW8&feature=youtu.be>

What is the Payback on IFMA's SFP Credential?

<http://www.youtube.com/watch?v=6ATNs483EYQ&feature=youtu.be>





IFMA Madison Chapter Calendar of Events

Some topics and tours are tentative and subject to change

November 2013

- 12 Executive Board Meeting
- 19 Chapter Luncheon Meeting

December 2013

- 10 Executive Board Meeting
- TBA Holiday Party

Our 2013-2014 Sponsors



Gold

Capital Fire & Security
CUNA Mutual Group
Pearson Engineering
Servpro of Madison
Shred-it
Strang, Inc.

Silver

Alliant Energy
Flad Architects
DTZ, Inc.

December Newsletter Deadline
Wednesday, November 27, 2013

Please submit materials to Jennifer Hardebeck
jhardebeck@central.esurance.com

IFMA Madison
INTERNATIONAL FACILITY MANAGEMENT ASSOCIATION
NEWS CREW

